

## **Hutchison-Hayes Separators, Inc.**

### **Model MRPX 514HGV-74C Parts List With Diagrams**

**P.O. Box 2965 ♦ Houston, Texas 77252**  
**3520 East Belt ♦ Houston, Texas 77015**  
**(713) 455-9600 ♦ Fax (713) 455-7753**

Type					
	MRPX 514HGV-74C	(C) MRPX 514-HGV-74C	(C) MRPX 514-HGV-74C	MRPX 514HGV-74C-60	(C) MRPX 514-HGV-74C-60
Prod.No.					
	881042-01-01	881042-01-02	881042-01-03	881042-02-01	881042-02-02
Machine Unit No.					
100	538544-81	538544-81	541805-02	538544-82	541805-03
200	540741-80	540741-81 540741-82	540741-81 540741-82	540741-81 540741-82	540741-81 540741-82
300	540893-01 540893-02 540893-03 540893-04	540893-01 540893-02 540893-03 540893-04	540893-01 540893-02 540893-03 540893-04	540893-05 540893-06	540893-05 540893-06
400	540922-80 540922-81	540922-80 540922-81	540922-80 540922-81	540922-80	540922-80
500	537687-88	537687-88	537687-88	537687-88	537687-88

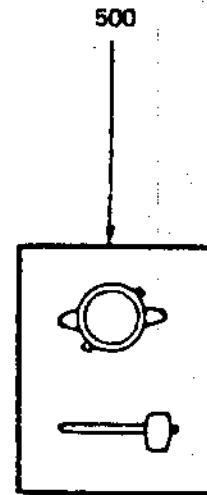
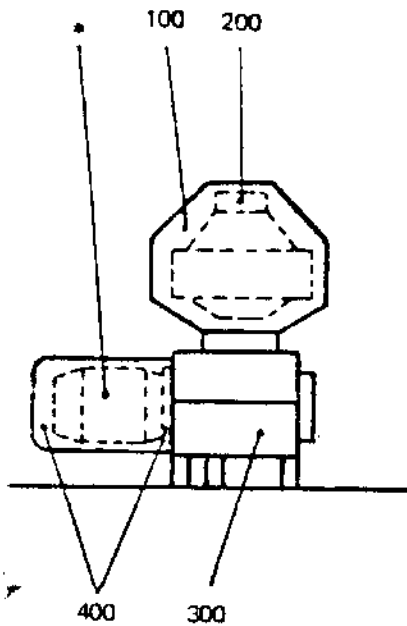

See separate printed matter

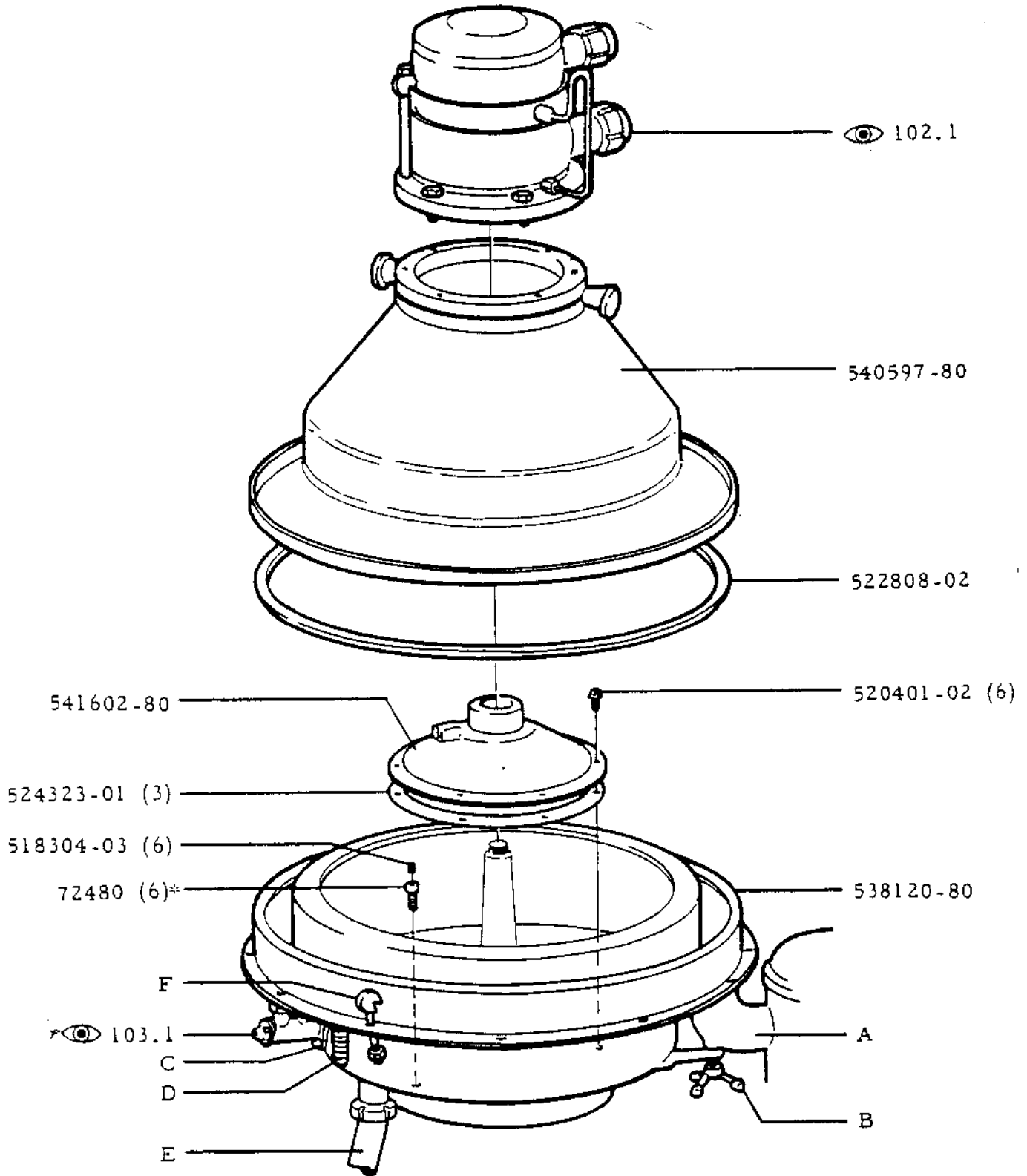

\* Loctite 270

A, B, C, D, E, F 101.1

Type/Prod No. (C) MRPX 514HGV-74C	Machine Unit No. 541805-02/03	Page <b>100.2</b>
Description Machine top part		Issue 1/80

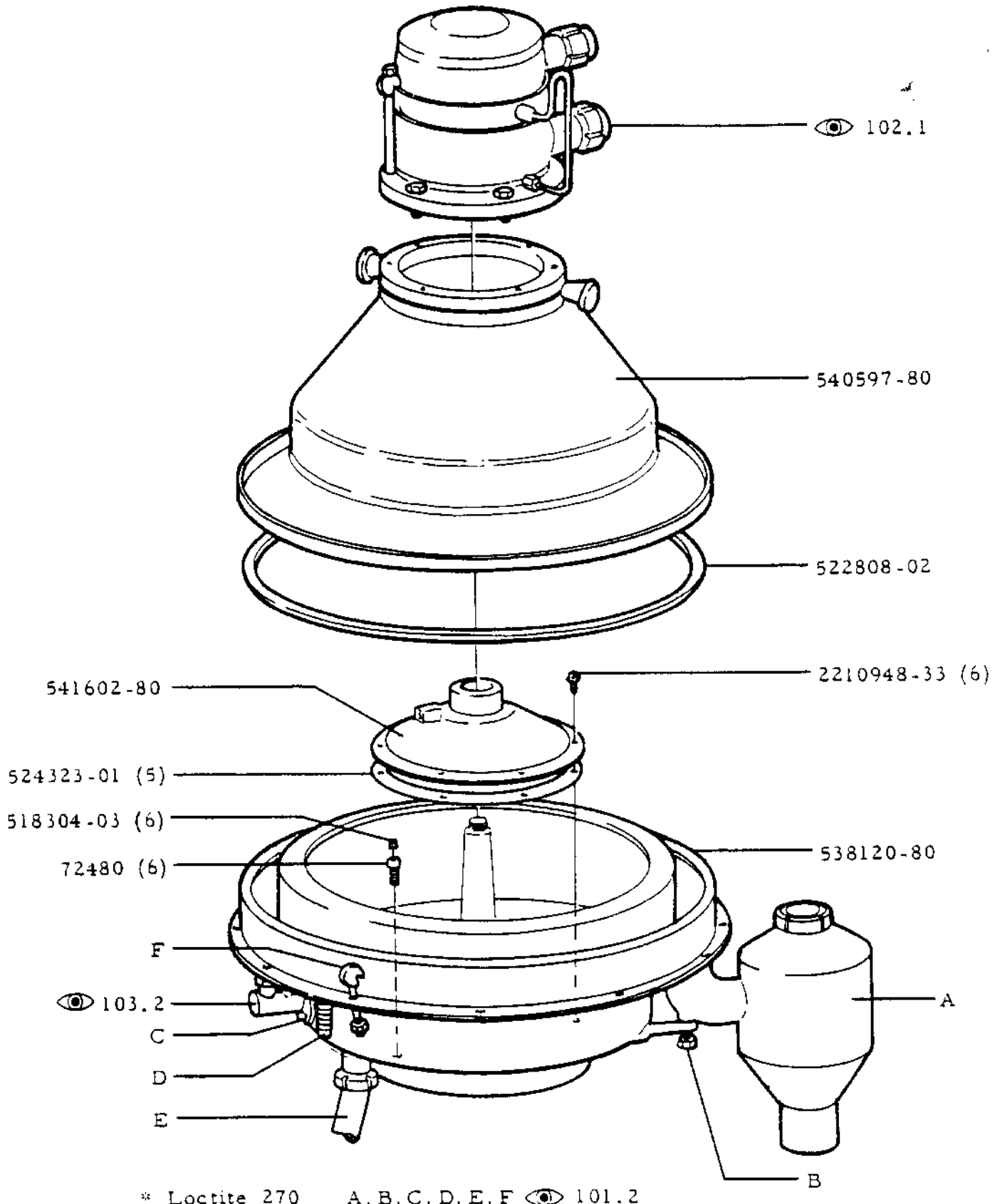

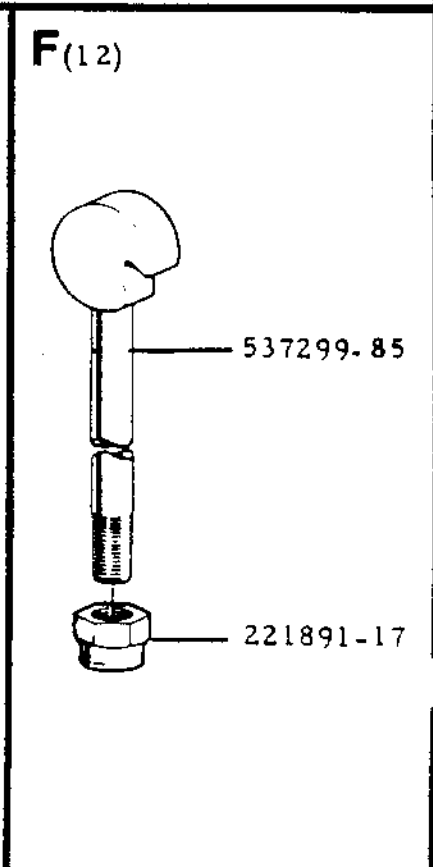
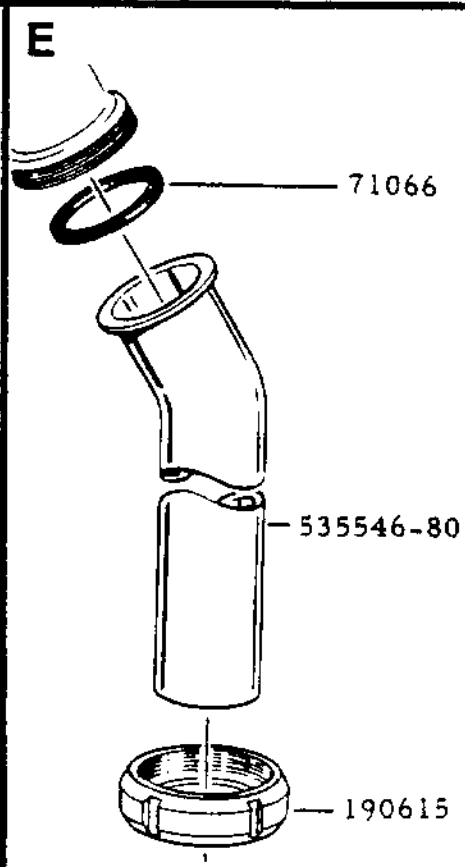
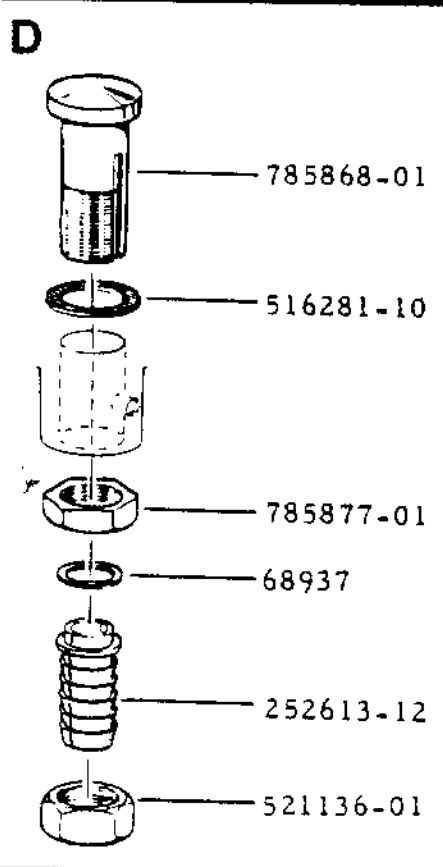
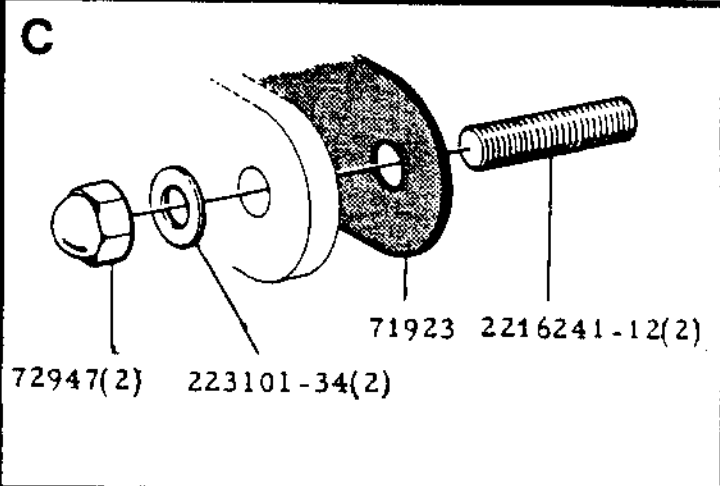
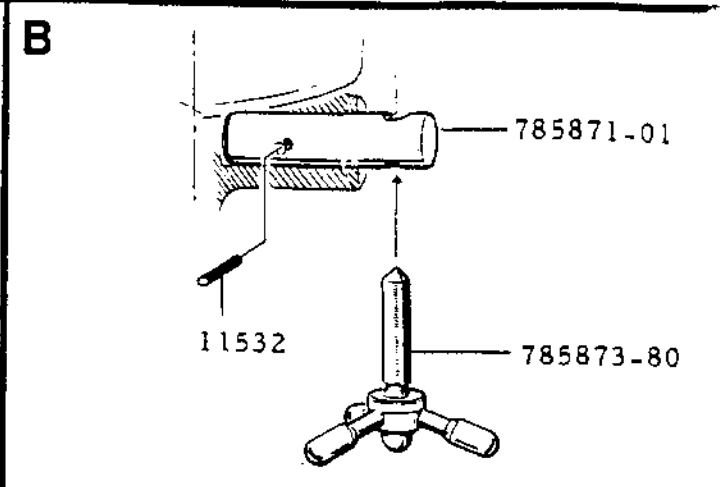
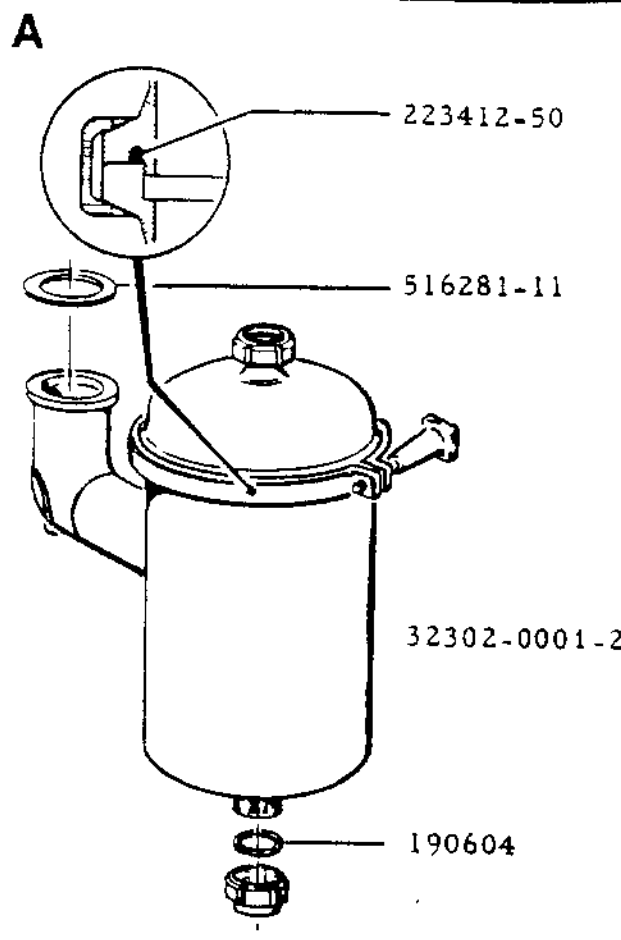

Type/Prod No.

(C) MRPX 514HGV-74C

Description

Discharge assembly

Machine Unit

538544-81/82

541805-02/03

Page

102.1

Issue

1/80

540625-80/81

Machine Unit No

- \* 538544-81/540625-02
- \*\* 538544-82/540625-03

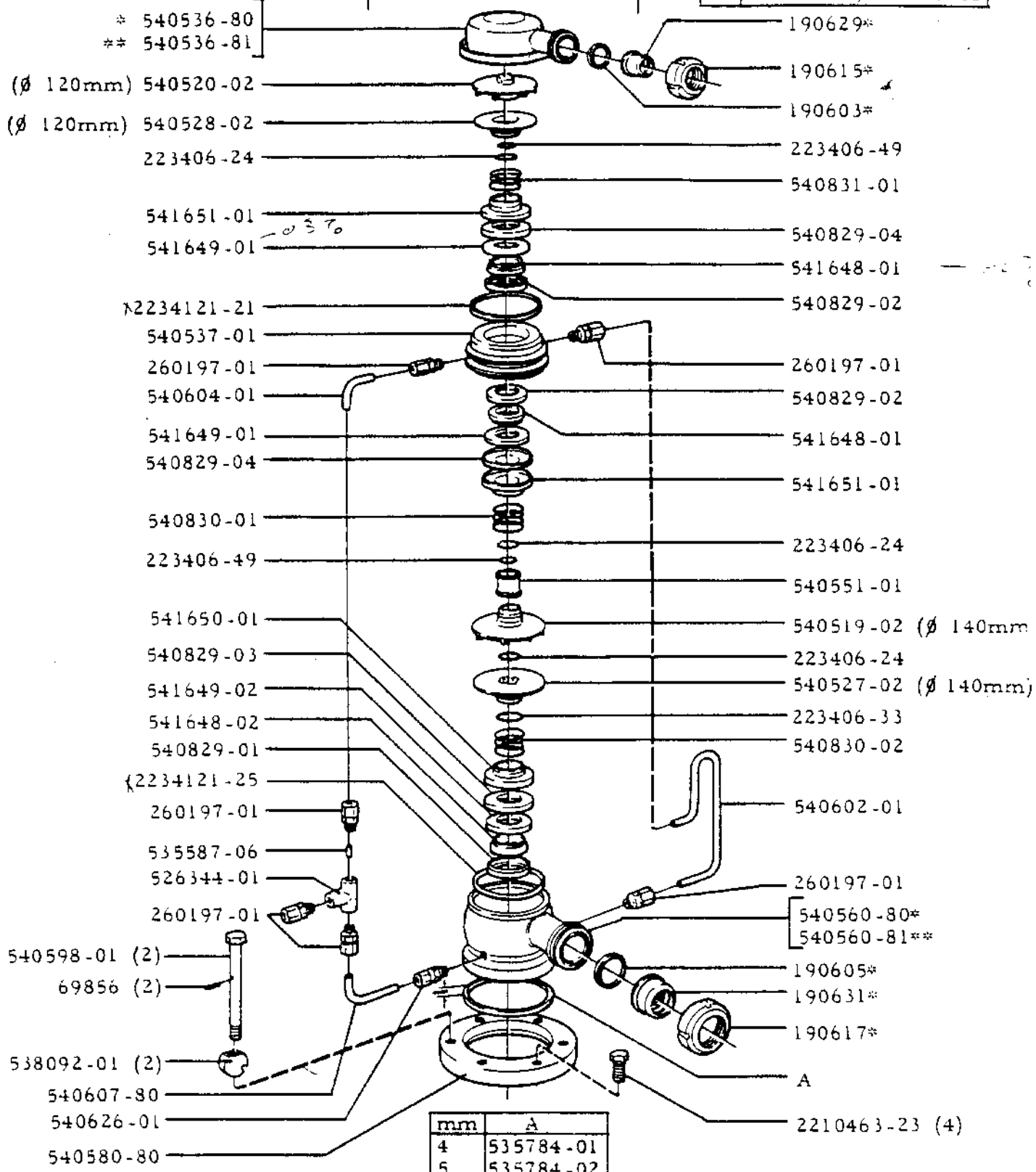

- \* 540536-80
- \*\* 540536-81

- (∅ 120mm) 540520-02
- (∅ 120mm) 540528-02

223406-24

541651-01

541649-01

2234121-21

540537-01

260197-01

540604-01

541649-01

540829-04

540830-01

223406-49

541650-01

540829-03

541649-02

541648-02

540829-01

{2234121-25

260197-01

535587-06

526344-01

260197-01

540598-01 (2)

69856 (2)

538092-01 (2)

540607-80

540626-01

540580-80

190629\*

190615\*

190603\*

223406-49

540831-01

540829-04

541648-01

540829-02

260197-01

540829-02

541648-01

541651-01

223406-24

540551-01

540519-02 (∅ 140mm)

223406-24

540527-02 (∅ 140mm)

223406-33

540830-02

540602-01

260197-01

540560-80\*

540560-81\*\*

190605\*

190631\*

190617\*

A

2210463-23 (4)

mm	A
4	535784-01
5	535784-02
6	535784-03
7	535784-04
8	535784-05

SO 3700

Type/Prod No. (C) MRPX 514HGV-74C	Machine Unit No. 538544 -81/82	Page 103.1
Description Control valve		Issue 1/80

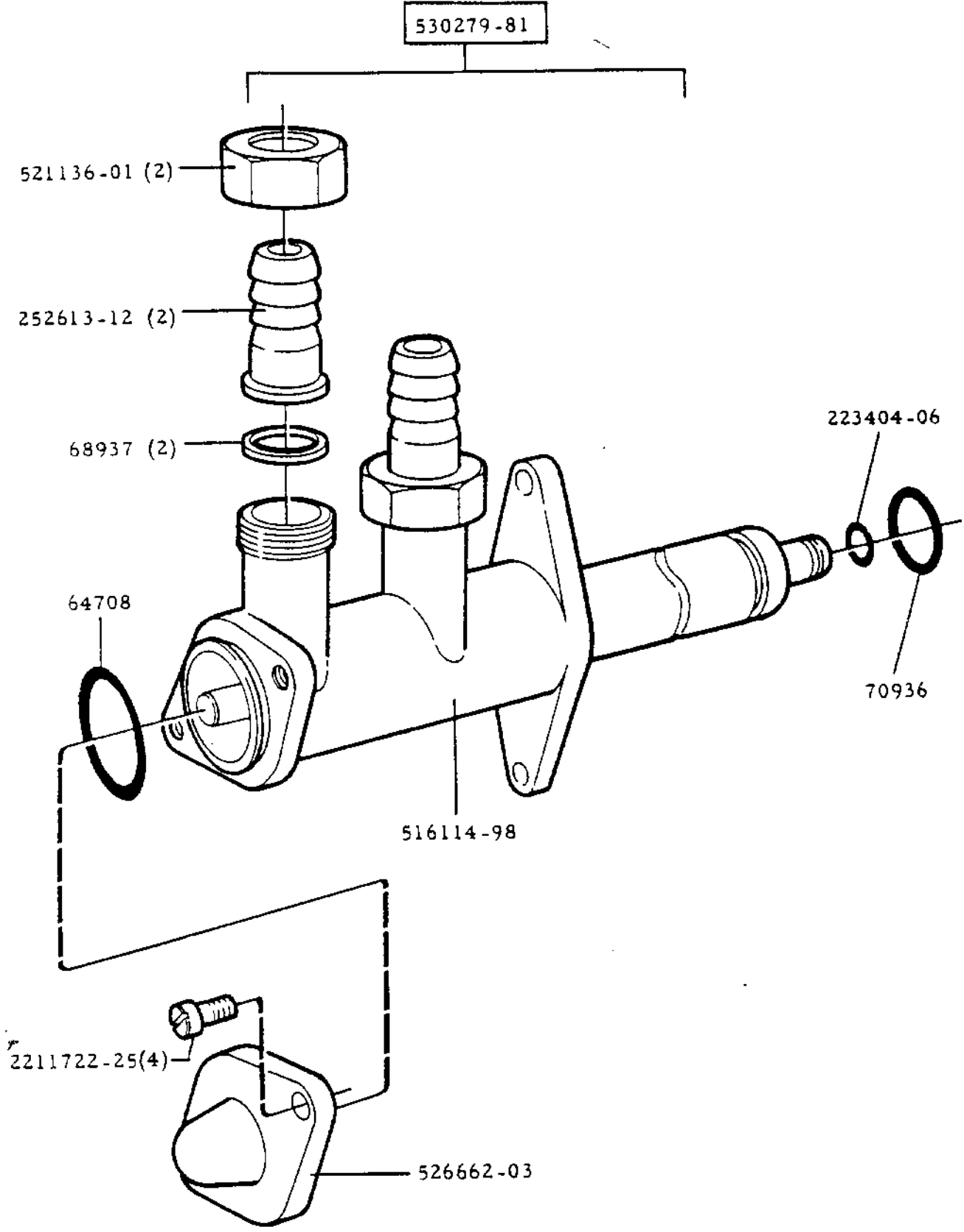

Type/Prod No. (C) MRPX 514HGV-74C	Machine Unit No. 541805-02/03	Page <b>103.2</b>
Description Connection piece for operating liquid		Issue 1/80

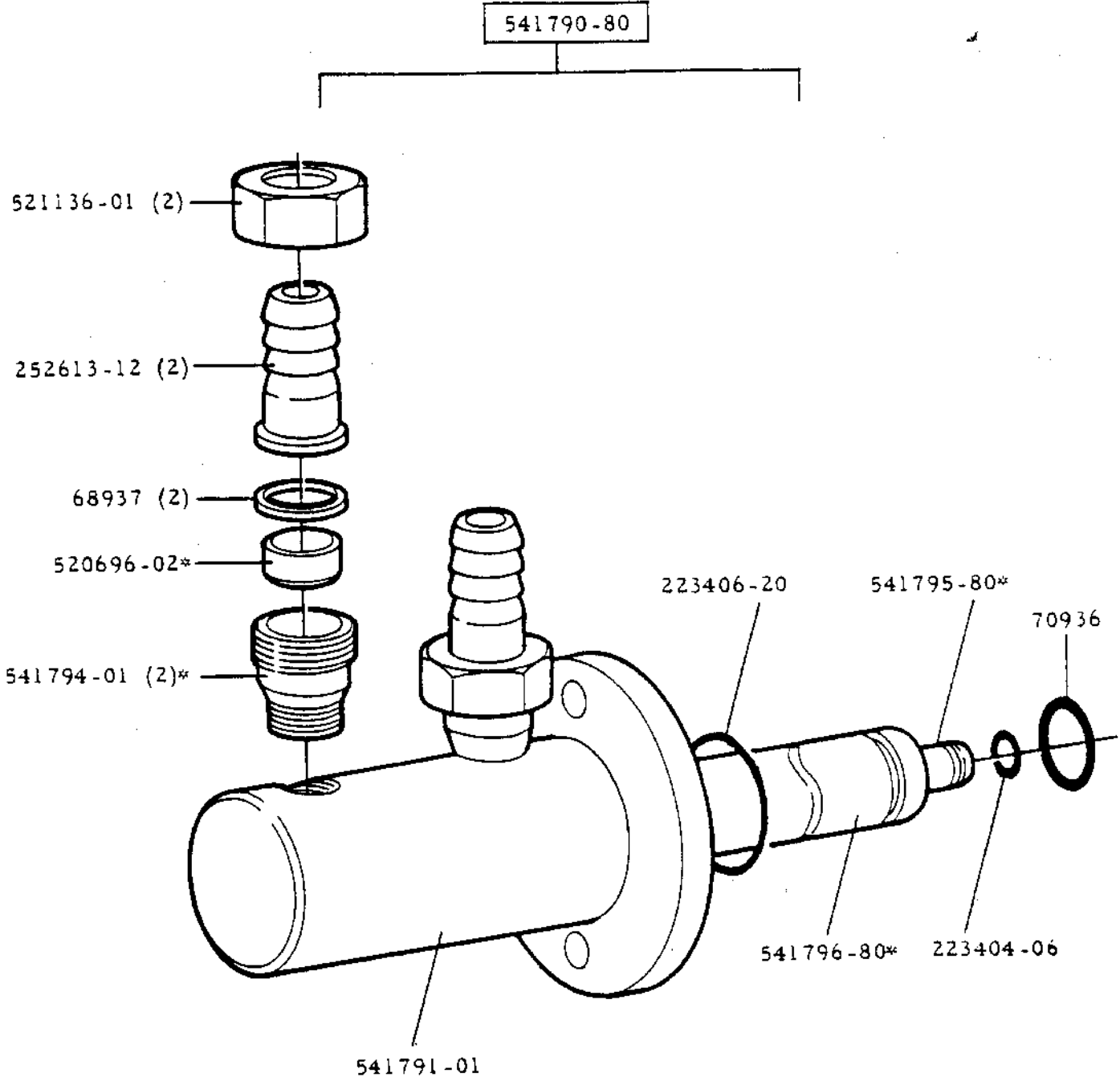

\* Loctite 270

Type/Prod No. (C) MRPX 514HGV-74C	Machine Unit No. 540893-01/02/03/04/05/06	Page <b>300.1</b>
Description Machine bottom part		Issue 1/80

Machine Unit No	Hz
540893-01/03	50
540893-02/04/05/06	60

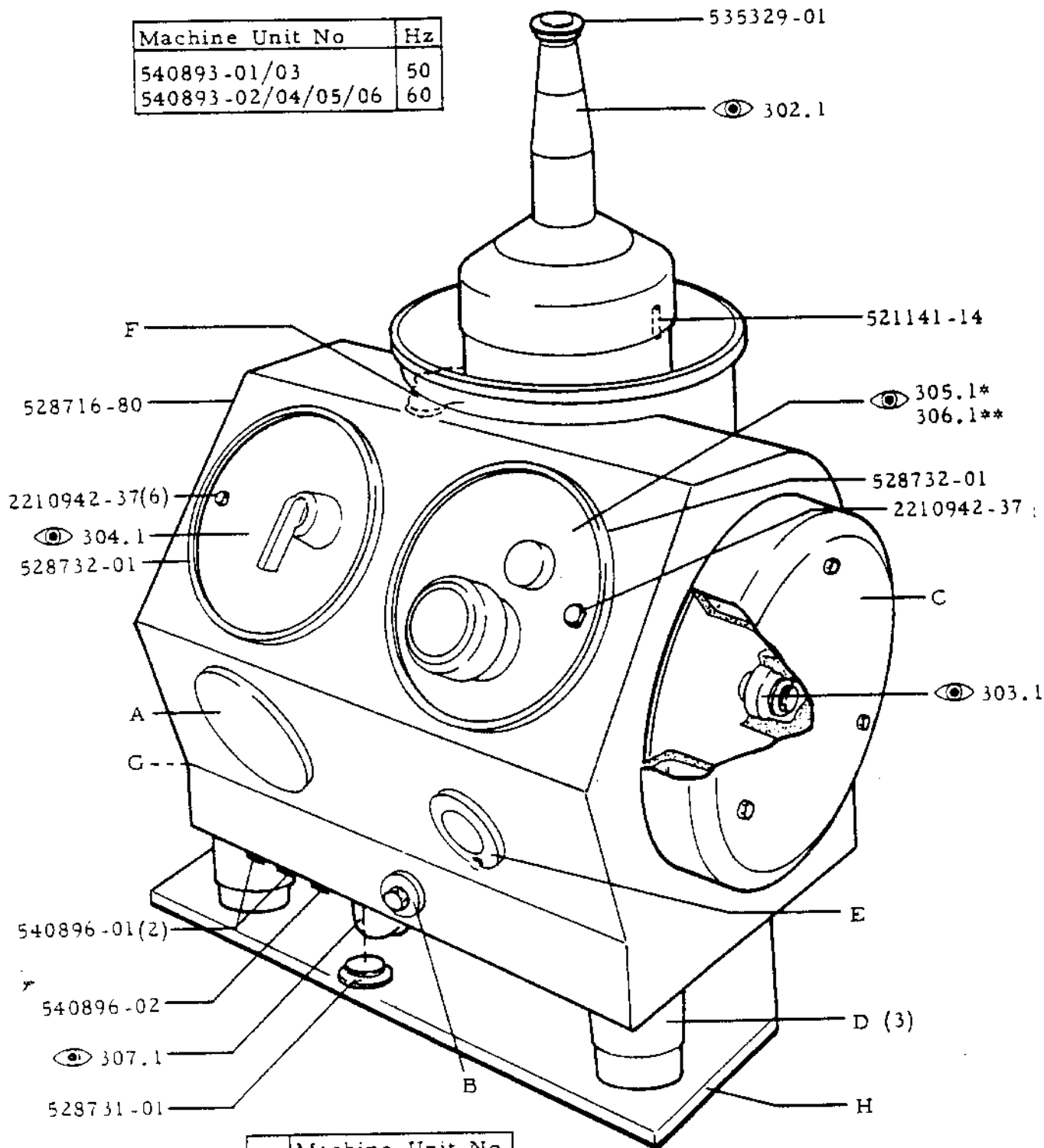

Machine Unit No	
*	540893-01/02/05
**	540893-03/04/06

A, B, C, D, E, F, G, H 301.1

Type/Prod No. (C) MRPX 514HGV-74C	Machine Unit No. 540741-80/81/82	Page <b>200.1</b>
Description Separator bowl		Issue 1/80

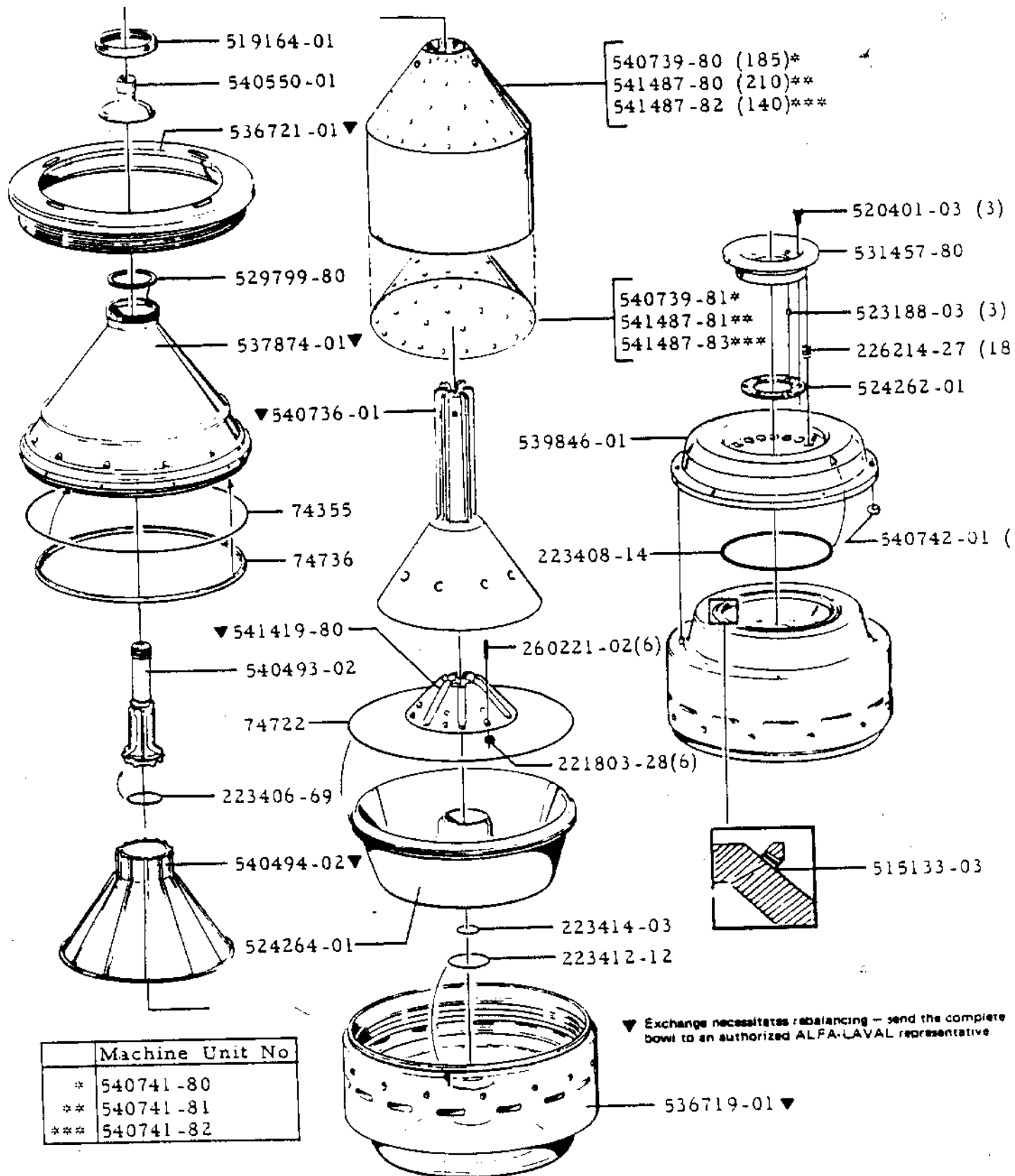

	Machine Unit No
*	540741-80
**	540741-81
***	540741-82

Type Prod. No.

(C) MRPX 514HGV-74C

Machine Unit No.

541805-02/03

101.2

Description

Frame parts

Issue

1/80

A

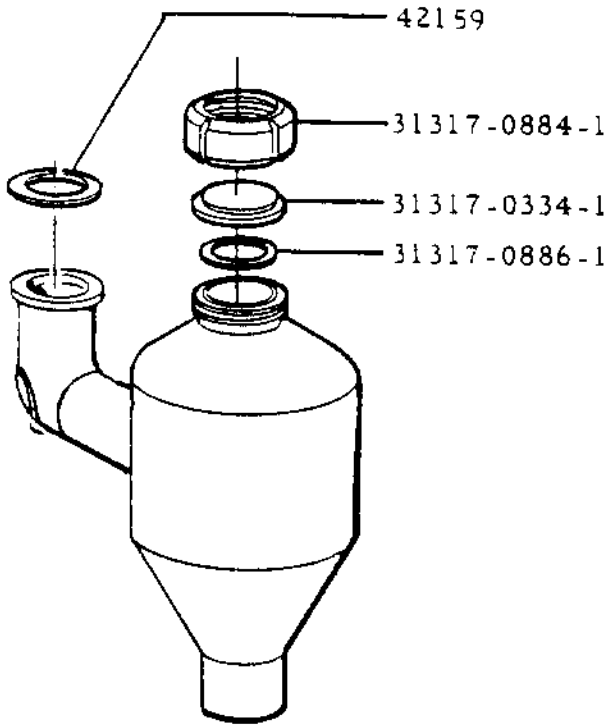

B

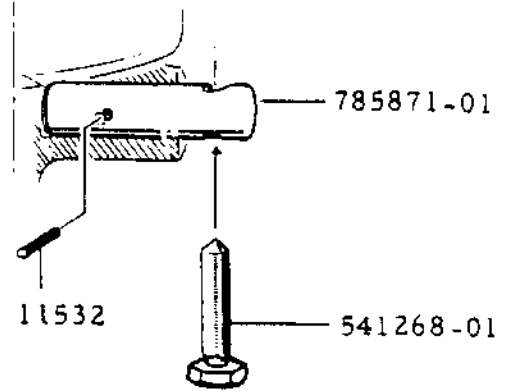

C

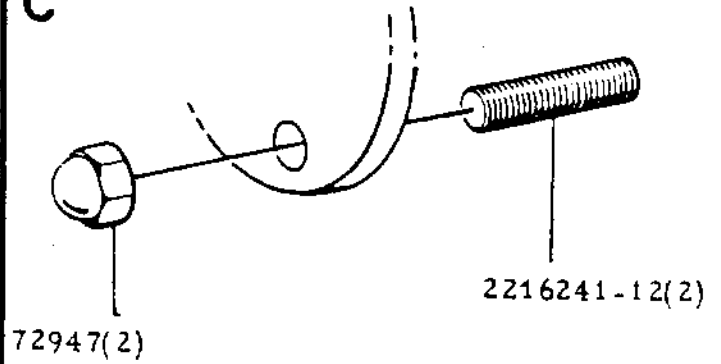

D

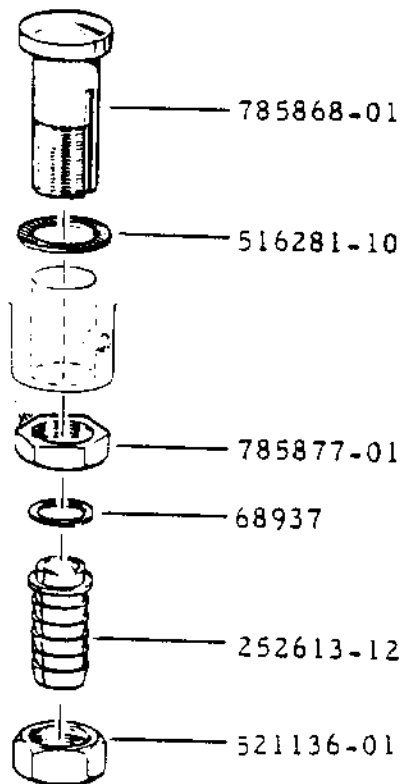

E

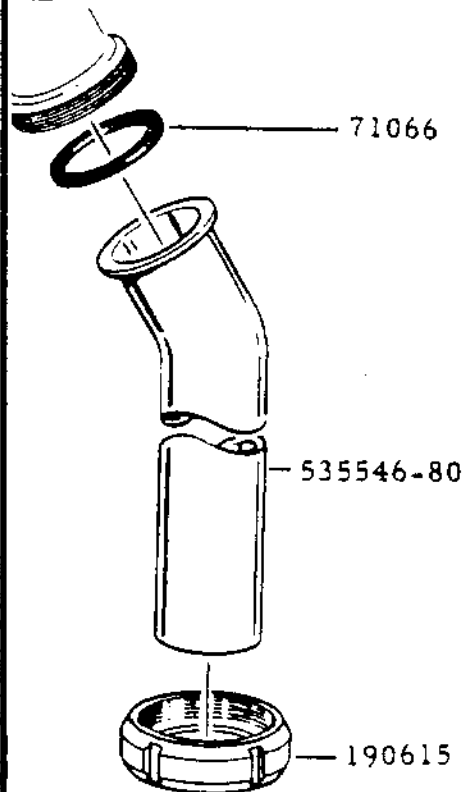

F(12)

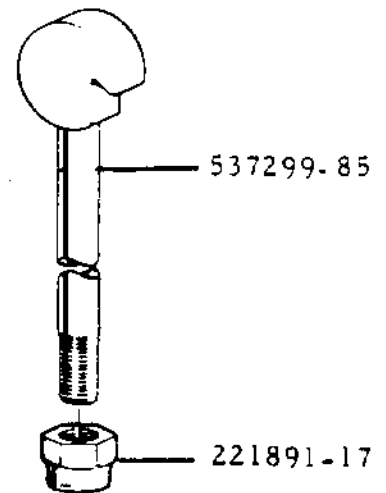

Type/Prod No. (C) MR.PX 514HGV-74C	Machine Unit No. 540893-01/02/03/04/05/06	Page 301.1
Description Frame parts		Issue 1/80

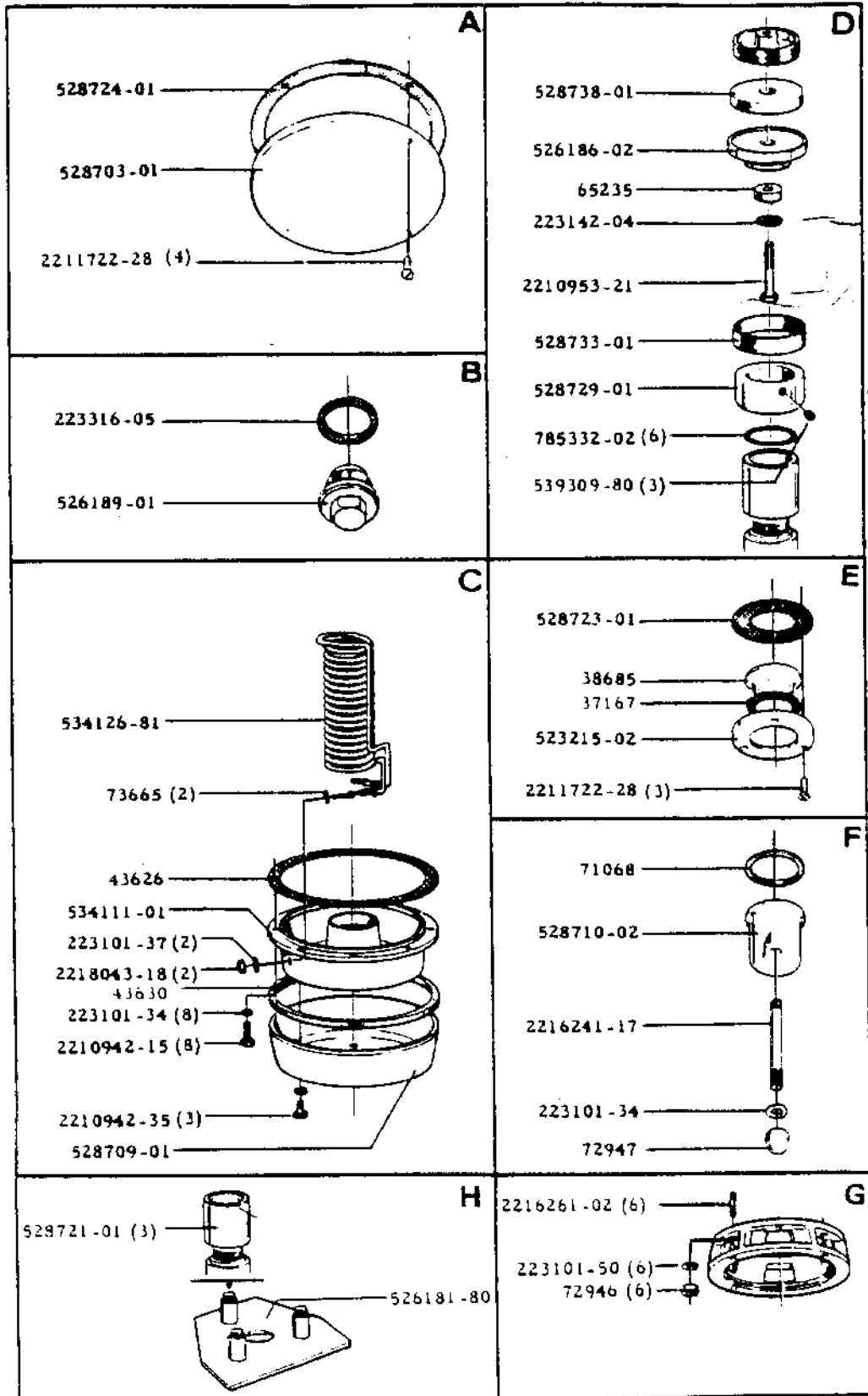

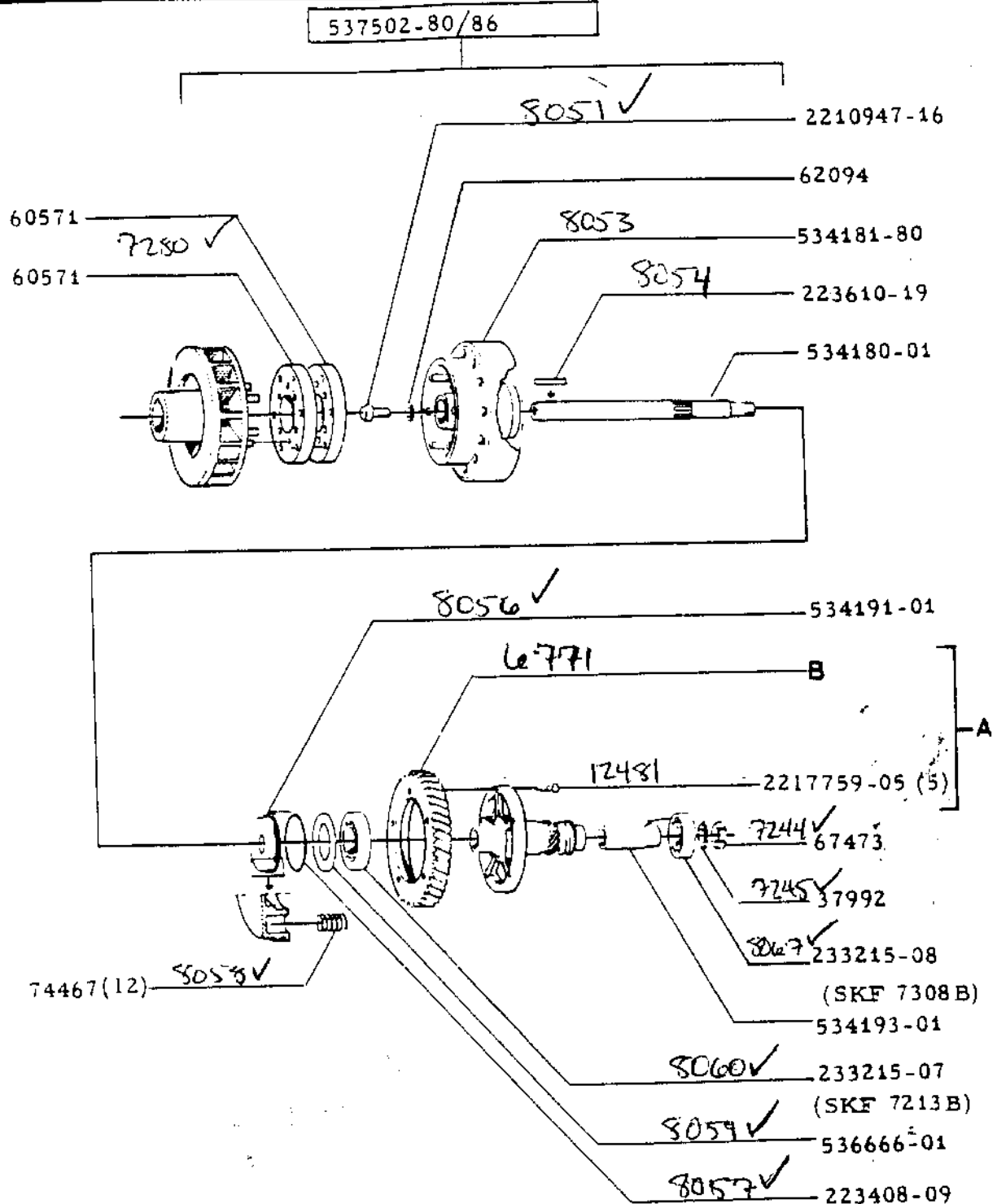

Machine Unit No	Hz	A	B
540893-01/03	50	538049-82	538051-05
540893-02/04/05/06	60	538049-83	538051-04

537484-94/95

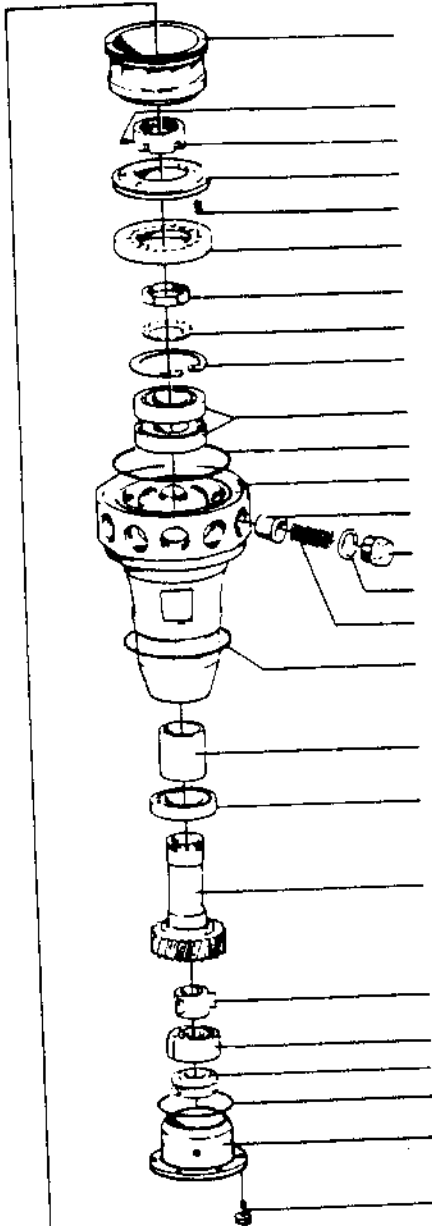
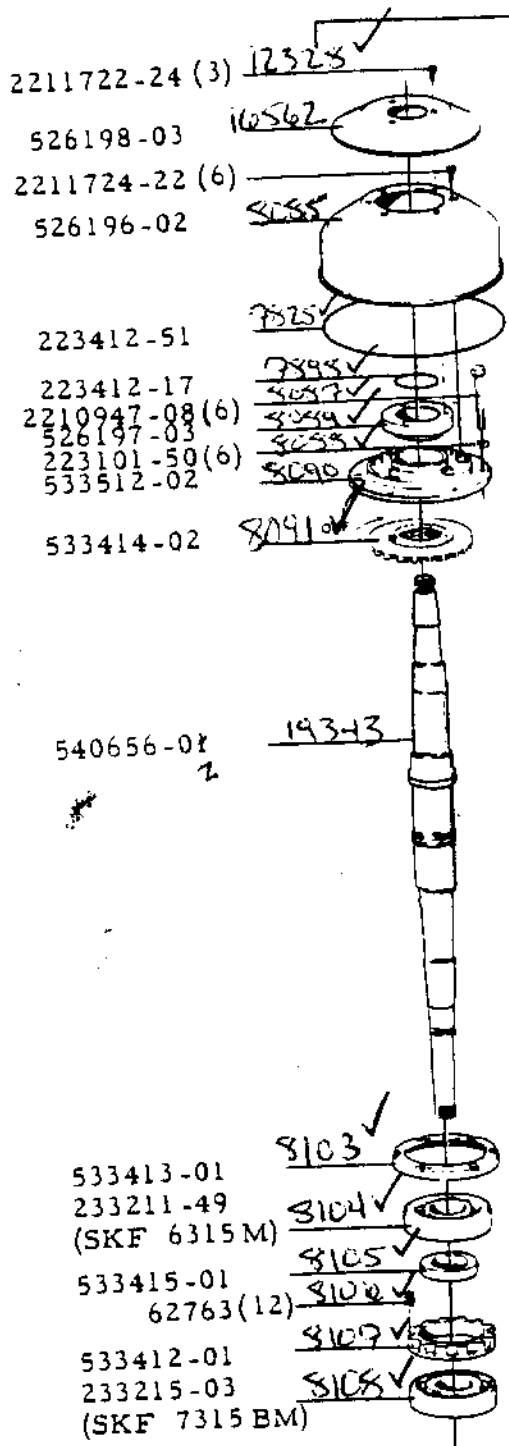

AUTO

Machine Unit No	Hz	A
540893-01/03	50	534275-17
540893-02/04/05/06	60	534275-16

Type/Prod No. (C) MRPX 514HGV-74C	Machine Unit No. 540893-01/02/03/04/05/06	Page <b>304.1</b>
Description Remote control brake		Issue 1/80

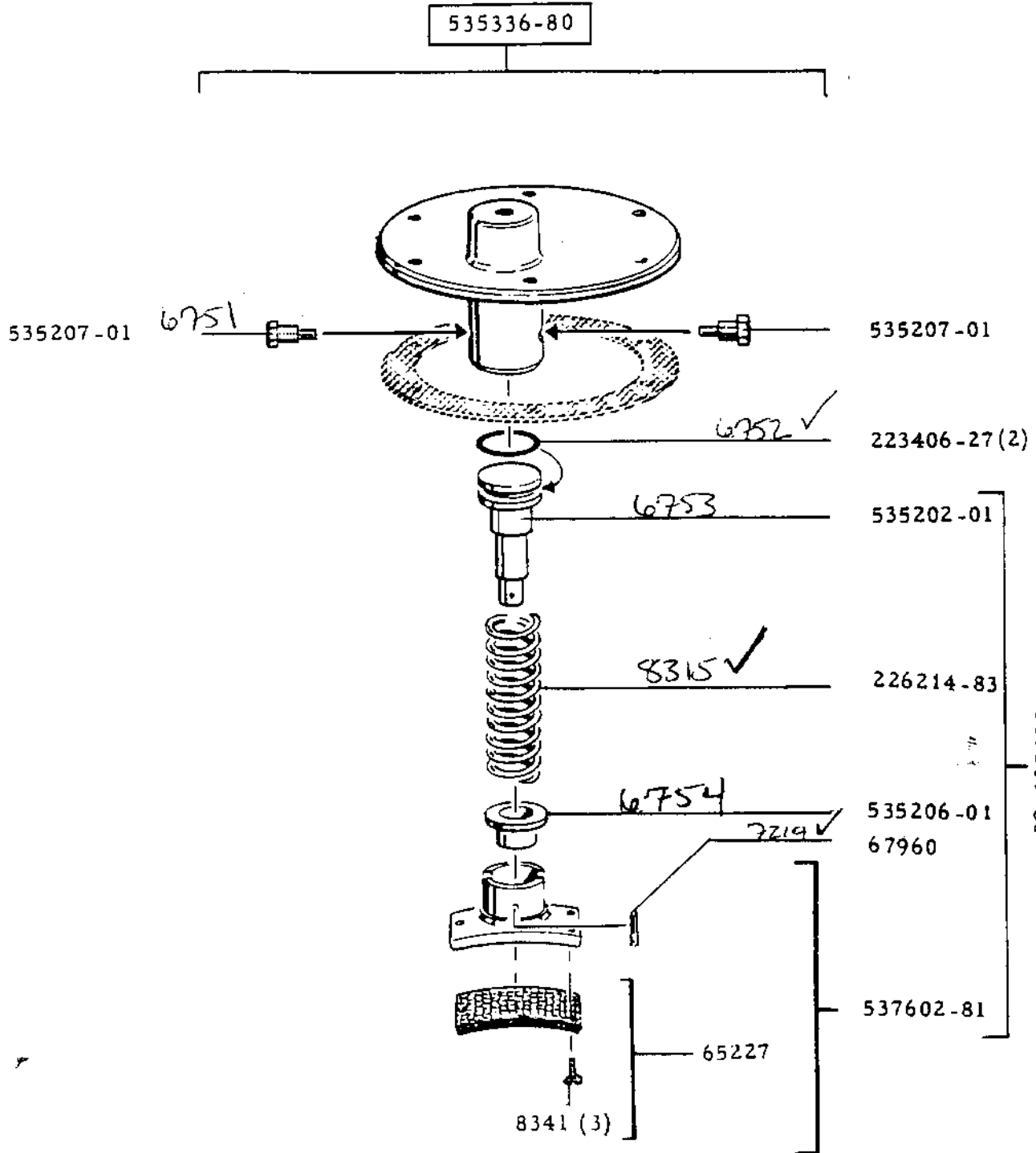

528753-82

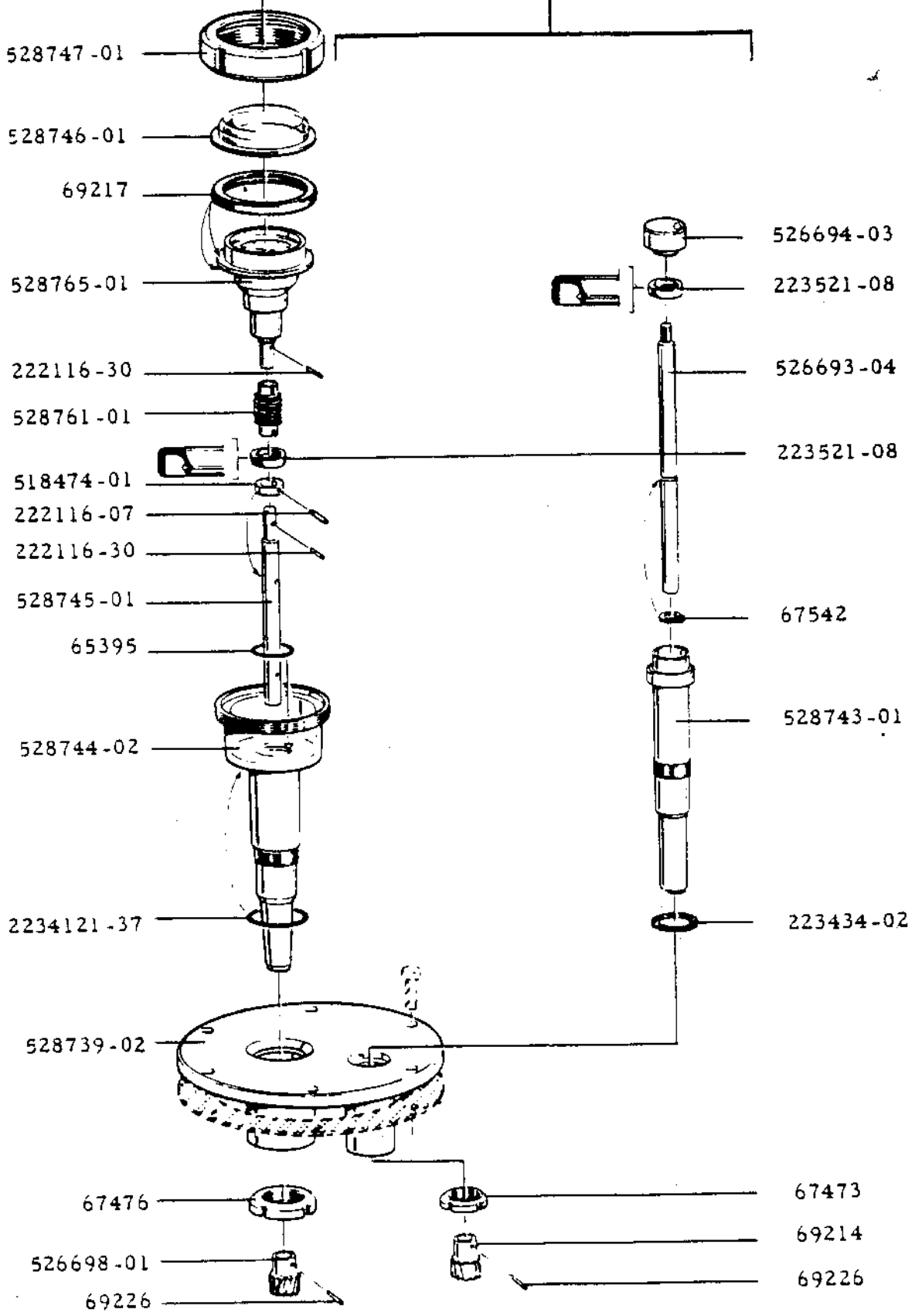

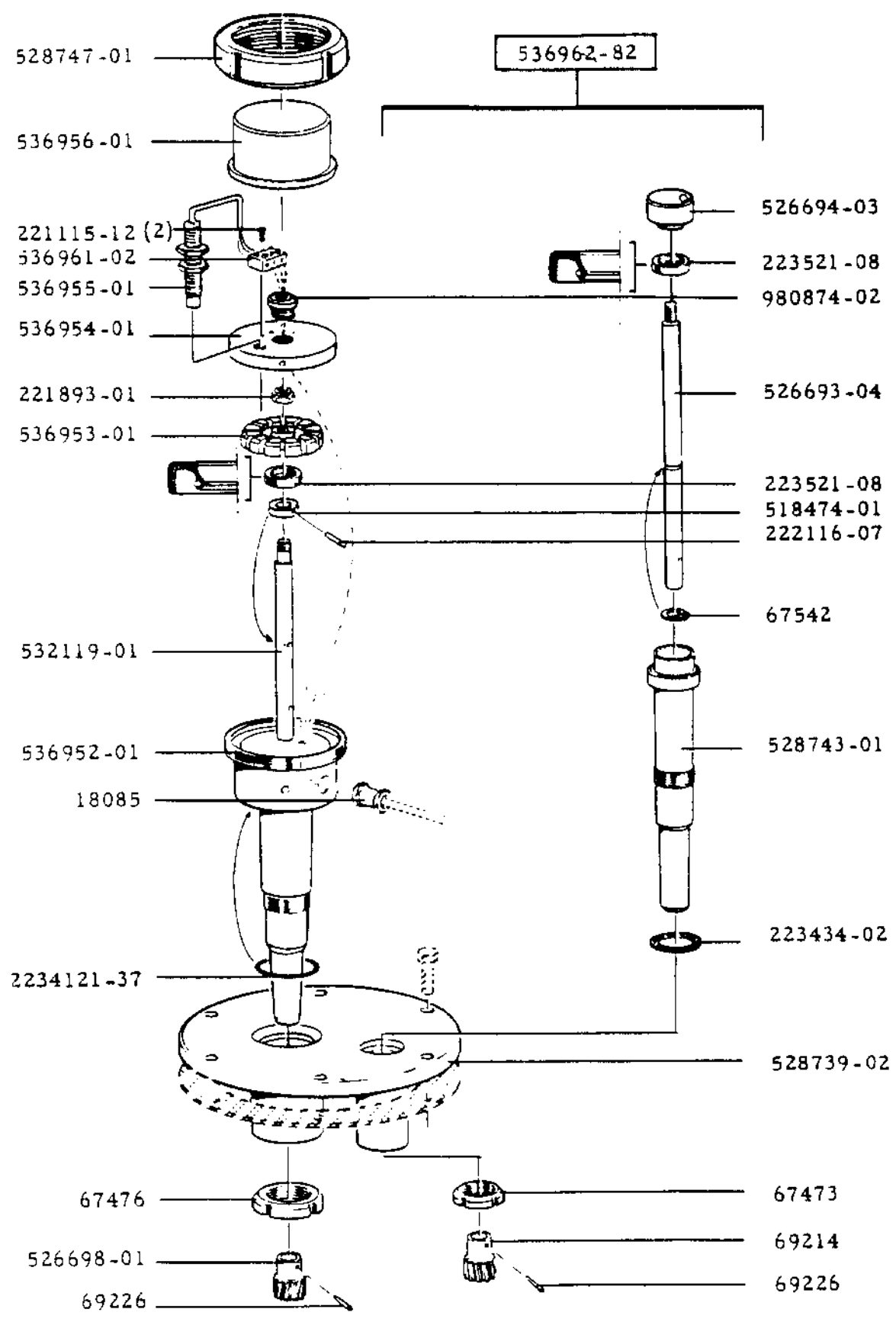

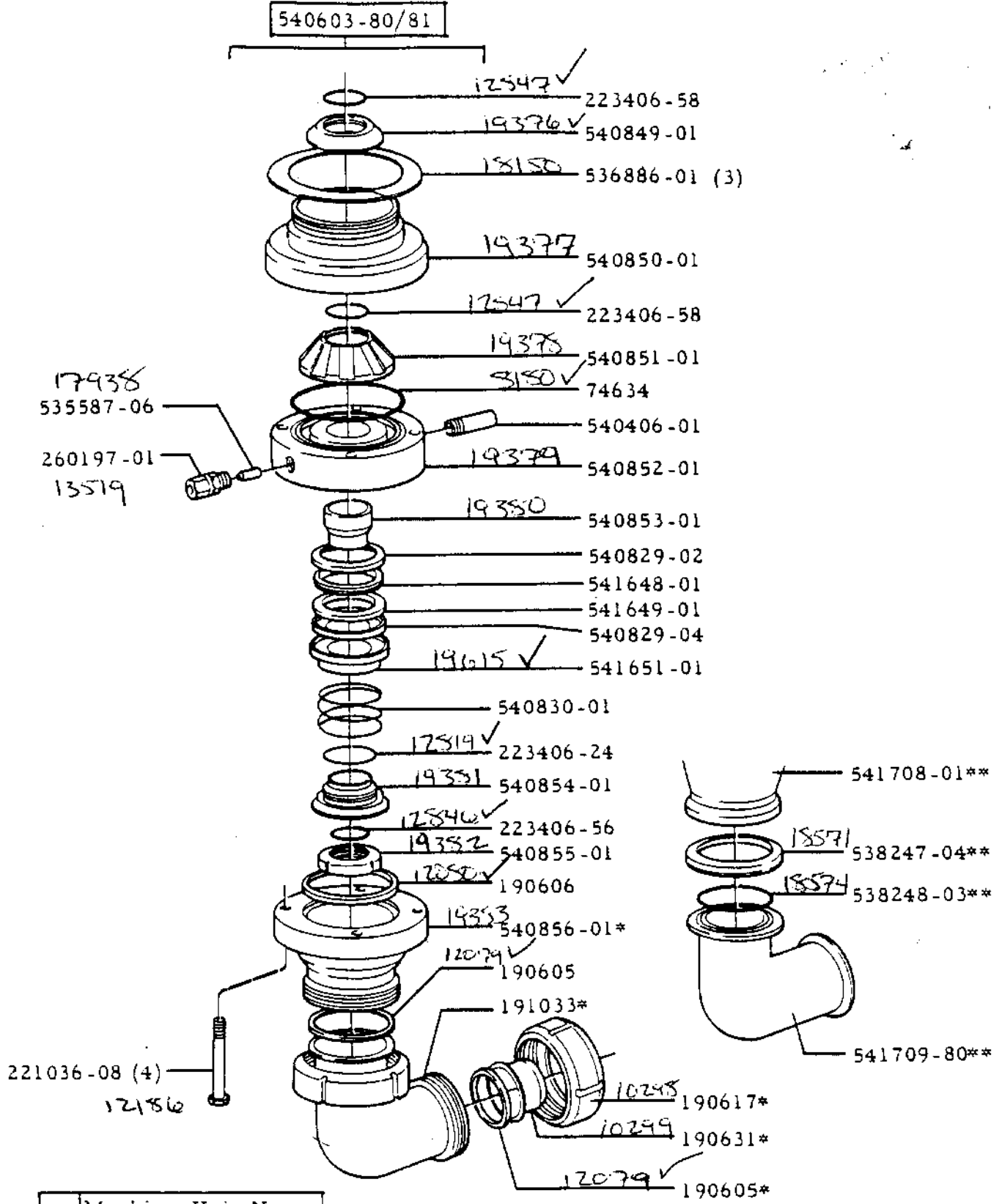

Machine Unit No	
*	540893-01/02/03/04
**	540893-05/06

Type/Prod No. (C) MR.PX 514HGV-74C	Machine Unit No. 540922-80/81	Page 400.1
Description Parts for mounting of motor		Issue 1/80

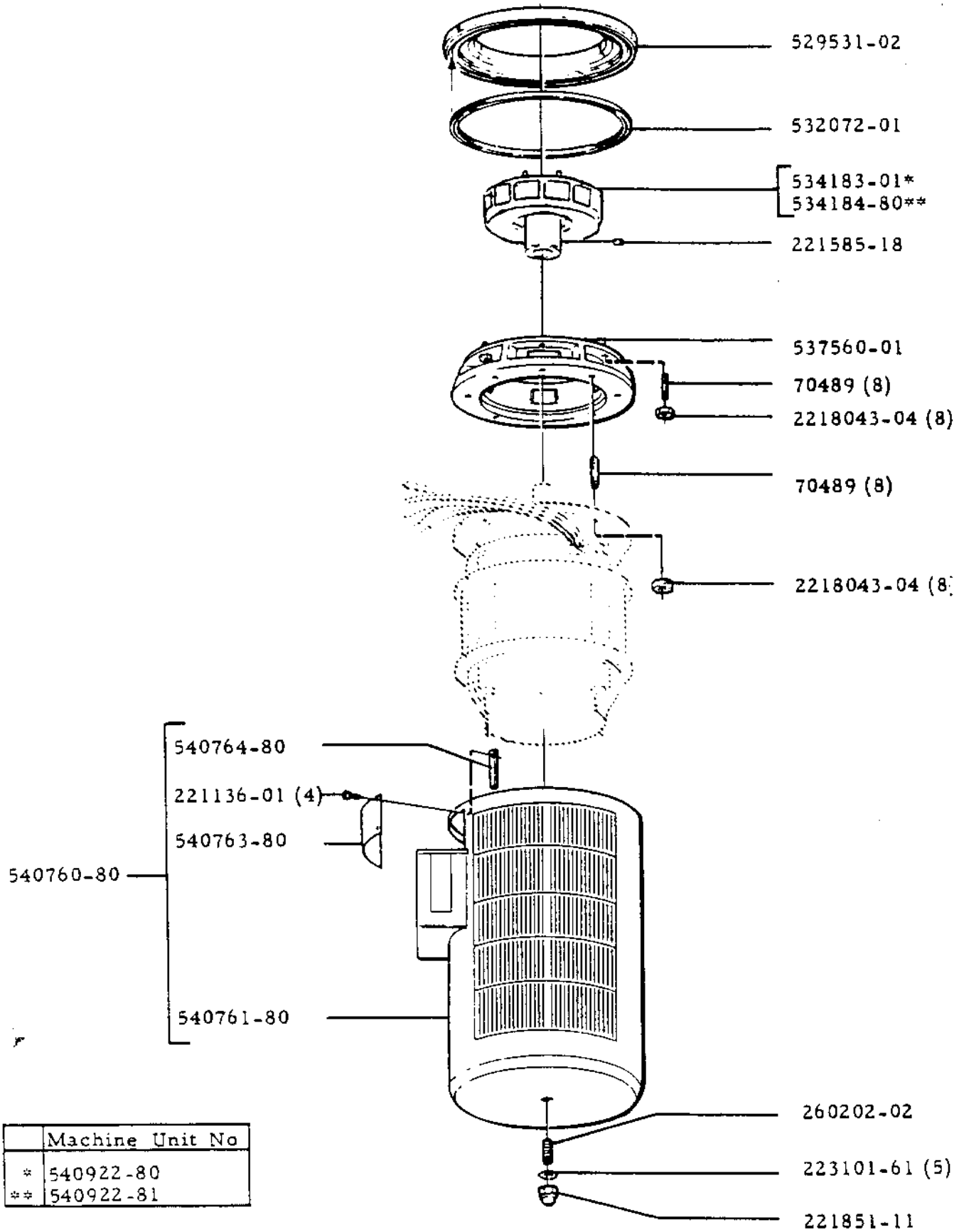

	Machine Unit No
*	540922-80
**	540922-81

Type/Prod No. (C) MRPX 514HGV-74C	Machine Unit No. 537687-88	Page <b>500.1</b>
Description Set of tools		Issue 1/80

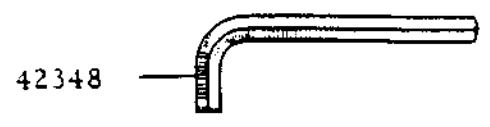

42348



69696

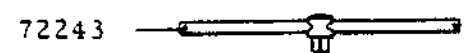

72243

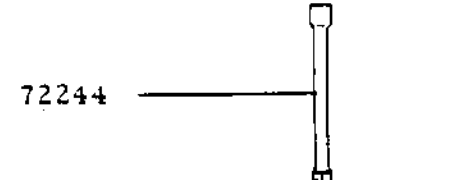

72244

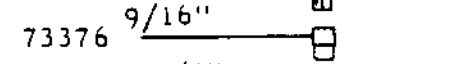

73376 9/16"

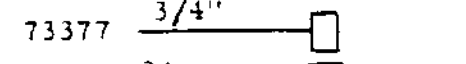

73377 3/4"

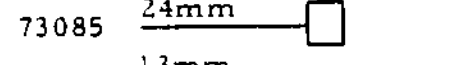

73085 24mm

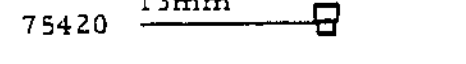

75420 13mm

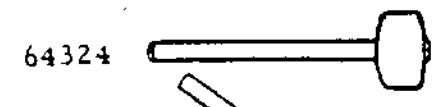

64324

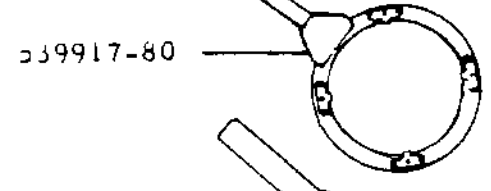

539917-80

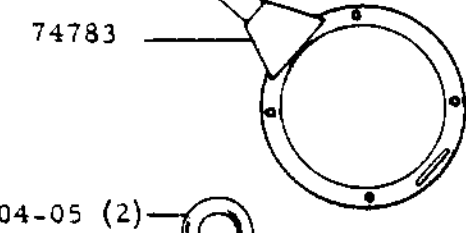

74783

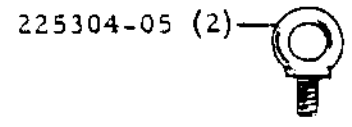

225304-05 (2)

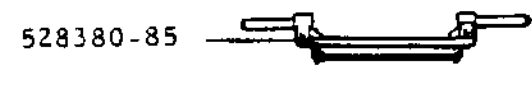

528380-85

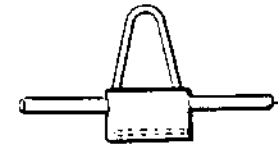

524317-80

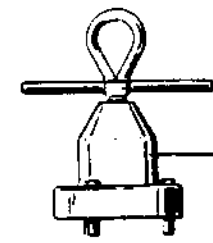

524301-80

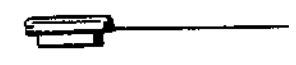

530313-02

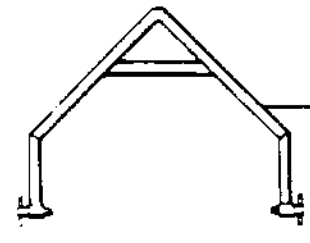

528350-81



540258-84\*

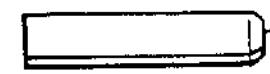

531296-80

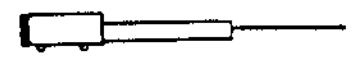

537707-80

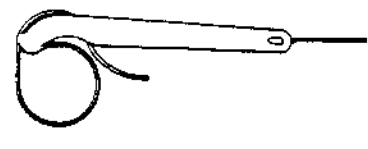

537446-01



538758-80

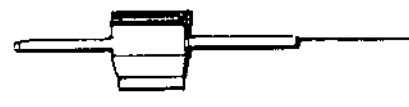

537944-01

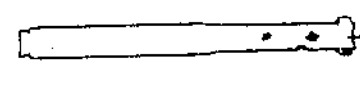

538779-80

\* for including parts - see separate printed matter

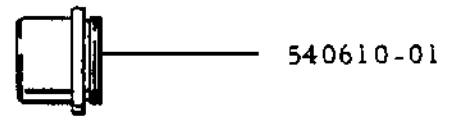
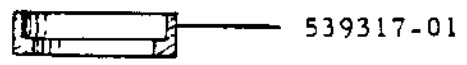
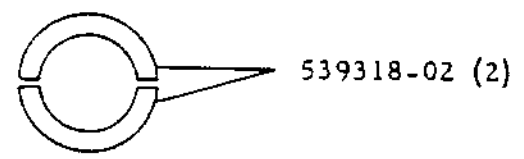
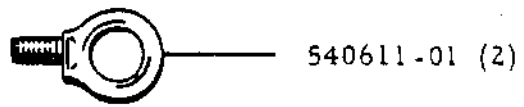
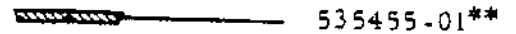
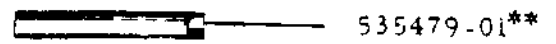
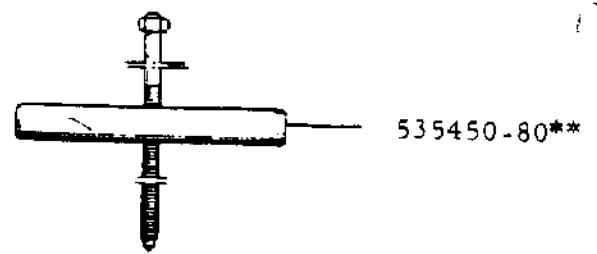
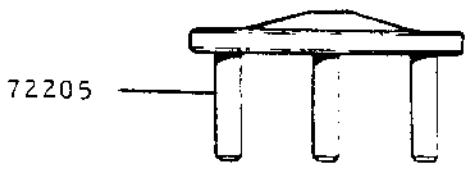
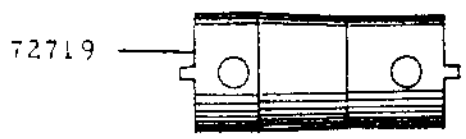
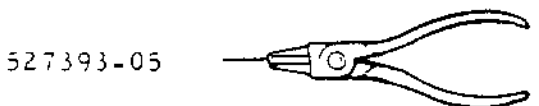
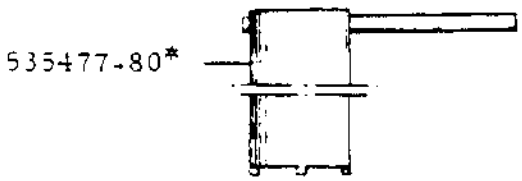
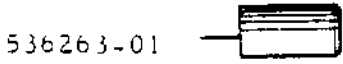

\* used together  
\*\* used together

PART NO	DESCRIPTION	PART NO	DESCRIPTION
8341	SCREW	71405	SLOTTED PIN
11532	PIN	71923	GASKET
14085	CABLE GLAND	71973	CONVEYOR
22451	BALL	72205	DRIVING -OFF TOOL
37167	RECTANGULAR RING	72243	T-HANDLE
37972	LOCK WASHER	72244	EXTENSION ROD
38411	O-RING	72473	WASHER
38685	GLASS DISK	72480	SCREW
42159	O-RING	72719	PIN SPANNER
42348	HEX SOCKET HEAD KEY	72946	NUT
43626	GASKET	72947	CAP NUT
43630	SEALING STRIP	73085	SOCKET FOR SOCKET SPANNE
60571	ELASTIC PLATE	73376	SOCKET FOR SOCKET SPANNE
62094	SPRING WASHER	73377	SOCKET FOR SOCKET SPANNE
62763	SPRING	73665	RECTANGULAR RING
64324	TIN HAMMER	74355	O-RING
64416	CYLINDRICAL PIN	74467	SPRING
64708	O-RING	74634	O-RING
65137	SING ROW RIG BALL BEARIN	74722	RECTANGULAR RING
65197	SPRING	74736	SEALING
65227	FRICTION PAD	74783	SPANNER
65235	RECTANGULAR RING	75420	SCKET FOR SOCKET SPANNE
65395	O-RING	190603	RECTANGULAR RING
66312	ROUND NUT	190605	RECTANGULAR RING
66313	LOCK WASHER	190606	RECTANGULAR RING
67440	PIN	190615	COUPLING NUT
67473	ROUND NUT	190617	COUPLING NUT
67476	ROUND NUT	190629	CONNECTING SLEEVE
67477	ROUND NUT	190631	LINER
67542	RETAINING RING	190996	SLEEVE
67762	CYLINDRICAL PIN	191033	ELBOW PIPE
67834	SCREW	221036 08	SCREW
67960	SLOTTED PIN	221115 12	SCREW
68937	RECTANGULAR RING	221121 55	SCREW
69214	GEAR WHEEL	221126 54	SCREW
69217	SEAL RING	221126 56	SCREW
69226	TAPER PIN	221136 01	SCREW
69676	HOOK SPANNER	221226 43	SCREW
69843	BALL BEARING	221230 10	SCREW
69850	ANGULAR CONTACT BALL BEA	221545 02	GRUB SCREW
69856	SLOTTED PIN	221581 06	GRUB SCREW
70340	SPRING	221581 31	SCREW
70346	BUFFER	221585 18	GRUB SCREW
70439	SCREW	221586 01	GRUB SCREW
70644	LIFTING TOOL	221803 28	NUT
70936	O-RING	221803 35	NUT
71066	RECTANGULAR RING	221851 11	CAP NUT
71068	RECTANGULAR RING	221891 17	LOCK NUT

PART NO	DESCRIPTION	PART NO	DESCRIPTION
221891	19 LOCK NUT	260189	01 BEARING
221893	01 LOCK NUT	260189	02 WASHER
222111	45 CYLINDRICAL PIN	260197	01 UNION
222116	07 PIN	260202	02 STUD BOLT
222116	18 SLOTTED PIN	260221	02 STUD BOLT
222116	22 SLOTTED PIN	515133	03 NOZZLE
222116	30 SLOTTED PIN	516114	98 CONNECTION PIECE
222116	41 SLOTTED PIN	516281	10 GASKET
223101	30 WASHER	516281	11 GASKET
223101	34 WASHER	518304	03 PLUG
223101	37 WASHER	518474	01 STOP RING
223101	30 WASHER	519164	01 LOCK RING
223101	51 WASHER	520401	02 SCREW
223101	55 WASHER	520401	03 SCREW
223101	61 WASHER	520555	80 SPINDLE COMPLETE
223142	04 WASHER	520696	02 BUSHING
223316	05 RECTANGULAR RING	521136	01 COUPLING NUT
223404	06 O-RING	521141	14 CYLINDRICAL PIN
223406	20 O-RING	522808	02 SEALING STRIP
223406	24 O-RING	523188	03 NOZZLE
223406	27 O-RING	523215	02 FIXING PLATE
223406	33 O-RING	524262	01 GASKET
223406	49 O-RING	524264	02 SLIDING BOWL BOTTOM
223406	56 O-RING	524301	80 LIFTING TOOL
223406	58 O-RING	524317	30 LIFTING TOOL
223406	69 O-RING	524323	01 GASKET
223406	09 O-RING	526181	82 FOUNDATION PLATE
223406	14 O-RING	526186	02 FRAME FOOT
223412	12 O-RING	526189	01 URAIN SCREW
223412	17 O-RING	526196	02 PROTECTING GUARD
223412	42 O-RING	526197	03 THROW-OFF COLLAR
223412	51 O-RING	526198	03 PROTECTING PLATE
223414	03 O-RING	526340	01 NIPPLE
223434	02 GASKET	526344	01 TEE, INTERNAL THREAD
223521	06 SEAL RING	526662	03 COVER
223610	19 KEY	526693	04 SHAFT
223642	35 RETAINING RING	526694	03 PROTECTING COLLAR
223654	05 LIFTING EYE	526698	01 WORM WHEEL
223811	02 SPRING	527393	05 MOUNTING TONG
226214	27 SPRING	525350	01 REVERSING TOOL
226214	33 SPRING	528352	01 SCREW WITH HANDLE
226314	27 BELLEVILLE WASHER	528380	05 LIFTING TOOL
233211	49 SING ROW RIG BALL BEARING	528705	01 COVER
233215	05 BALL BEARING	528709	01 PROTECTING GUARD
233215	07 ANGULAR CONTACT BALL BEA	528710	02 CONNECTING ELBOW
233215	05 ANGULAR CONTACT BALL BEA	528716	03 FRAME BOTTOM PART
234613	12 HOSE SLEEVE	528721	01 CAP
234614	03 LIFTING EYE	528723	01 GASKET

PART NO	DESCRIPTION	PART NO	DESCRIPTION
528724	01 GASKET	534275	16 WORM
528729	01 HOLDER	534275	17 WORM
528731	01 PLUG	534276	01 SPACING SLEEVE
528732	01 GASKET	535201	80 BRAKE SHOE
528733	01 PROTECTING RING	535202	01 PISTON ROD
528738	01 RUBBER CUSHION	535206	01 GLAND
528743	01 BUSHING	535207	01 GRUB SCREW
528744	02 BUSHING	535329	01 CAP NUT
528745	01 SHAFT	535336	80 REMOTE CONTROL BRAKE
528746	01 PROTECTING GLASS	535450	80 EXPELLING AND DRIVING-I
528747	01 LOCK RING	535453	01 THRUST DISK
528753	82 WORM WHEEL GUARD	535454	01 THRUST DISK
528761	01 FLEXIBLE COUPLING	535455	01 EXTRACTOR DISK
528765	01 TACHOMETER	535455	02 EXTRACTOR DISK
528776	01 SCREW PLUG	535477	80 PIN SPANNER
528929	11 V-RING	535478	80 HOLDING TOOL
529531	02 GUIDE RING	535479	01 PIPE
529799	06 RECTANGULAR RING	535546	80 DRAIN PIPE
530007	03 SWITCH	535555	01 HOOK SPANNER
530028	01 ROUND NUT	535587	06 NOZZLE
530035	80 YOKE COMPLETE	535784	01 HEIGHT ADJUSTING RING
530279	81 OPERATING DEVICE	535784	02 HEIGHT ADJUSTING RING
530313	02 PLUG	535784	03 HEIGHT ADJUSTING RING
531296	80 DRIVING-OFF TOOL	535784	04 HEIGHT ADJUSTING RING
531457	80 SPRING SUPPORT	535784	05 HEIGHT ADJUSTING RING
532072	01 SEAL STRIP	535785	01 SUPPORTING SLEEVE
532119	01 SHAFT	535839	01 SUPPORT
533411	01 BALL BEARING HOUSING	535861	01 PROTECTING CAP
533412	01 SPRING SUPPORT	535899	01 PLUG
533413	01 LOCK RING	536233	01 LOCK SWITCH ACTUATOR
533414	02 OIL PAN	536263	01 SLEEVE
533415	01 SPACING SLEEVE	536666	01 THRUST DISK
533416	01 STOP RING	536719	01 BOWL BODY
533417	01 WEAR RING	536721	01 LOCK RING
533418	01 SPRING SUPPORT	536783	01 THROW-OFF COLLAR
533512	02 COVER	536791	01 ROLLER
534111	03 BEARING SHIELD	536886	01 HEIGHT ADJUSTING RING
534126	81 COOLING COIL	536952	01 BUSHING
534127	01 MAGNET	536953	01 TOOTHED WHEEL
534128	01 WASHER	536954	01 WASHER
534143	01 SPRING CASING	536955	01 INDUCTIVE SENSOR
534160	01 WORM WHEEL SHAFT	536958	01 COVER
534181	80 COUPLING DRUM	536961	02 TERMINAL BOARD
534183	01 COUPLING DISK	537086	02 MOLYBDENUM DISULFIDE P.
534184	80 COUPLING DISK	537299	85 HOOK SCREW
534191	01 SEALING WASHER	537446	01 BELT PIPE WRENCH
534193	01 SPACING SLEEVE	537560	01 MOTOR ADAPTER
534223	80 PULLER TOOL	537602	81 BRAKE SHOE

PART NO	DESCRIPTION	PART NO	DESCRIPTION
537667	39 SET OF TOOLS	540626	01 COUPLING
537707	30 PIN SPANNER	540632	02 WRENCH HEAD
537874	01 BOWL HOOD	540656	01 BOWL SPINDLE
537944	01 LIFTING RING	540736	01 DISTRIBUTOR
538049	32 WORM WHEEL COMPLETE	540739	80 BOWL DISK
538049	33 WORM WHEEL COMPLETE	540739	81 BOWL DISK
538051	04 GEAR R14	540741	80 SEPARATOR BOWL
538051	05 GEAR R14	540741	81 SEPARATOR BOWL COMPLE
538092	01 HOOK	540741	82 SEPARATOR BOWL
538120	80 FRAME TOP PART COMPLETE	540742	01 VALVE PLUG
538247	04 HINGED TGGLE CLAMP	540760	80 PROTECTING CAP
538248	03 BASKET	540761	80 PROTECTING CAP
538544	81 MACHINE TOP PART	540763	80 TOP COVER
538544	82 MACHINE TOP PART	540764	80 SUPPORT
538758	40 PULLER RING	540829	01 PACKING
538778	01 WRENCH HEAD	540829	02 PACKING
538779	01 TORQUE WRENCH	540829	04 PACKING
538779	80 TORQUE WRENCH	540830	01 COMPRESSION SPRING
539309	80 SOCKET GRUB SCREW	540830	02 COMPRESSION SPRING
539317	01 PULLER RING	540831	01 COMPRESSION SPRING
539318	02 SEGMENT	540849	01 DEFLECTOR
539846	01 OPERATING SLIDE	540850	01 HOLDER
539917	30 SPANNER FOR LOCK RING	540851	01 IMPELLER
540291	01 WASHER	540852	01 INTERMEDIATE PART
540292	01 LOCK WASHER	540853	01 CONVEYOR SLEEVE
540293	01 THRUST WASHER, OUTER	540854	01 GUIDE SLEEVE
540295	34 COMPRESSION TOOL	540855	01 NUT
540298	35 SERVICE UNIT	540856	01 INLET HOUSING
540406	01 TRIPPLE	540893	01 MACHINE BOTTOM PART
540473	02 GULLET PIPE	540893	02 MACHINE BOTTOM PART
540494	02 TOP DISK FINISH MACHINED	540893	03 MACHINE BOTTOM PART
540519	02 IMPELLER TOP PART	540893	04 MACHINE BOTTOM PART
540520	02 IMPELLER TOP PART	540893	05 MACHINE BOTTOM PART
540527	02 IMPELLER BOTTOM PART	540893	06 MACHINE BOTTOM PART
540528	02 IMPELLER BOTTOM PART	540896	01 PLUG
540530	80 DISCHARGE HOUSING	540896	02 PLUG
540537	01 INTERMEDIATE PART	540922	80 PARTS FOR MOTOR MOUNT
540550	01 GUIDE SLEEVE	540922	81 PARTS FOR MOTOR MOUNT
540551	01 SPACING SLEEVE	540934	30 LOCK SWITCH
540553	80 DISCHARGE HOUSING	541263	01 CLAMP SCREW
540557	30 CENTERING RING	541272	80 CYCLONE
540597	30 FRAME HOOD	541272	81 CYCLONE, COMPL
540596	01 SCREW	541276	01 SEAL SLEEVE
540602	01 PIPE	541419	80 DISTRIBUTING CONE
540604	01 PIPE	541487	80 BOWL DISK
540607	30 PIPE WITH NOZZLE	541487	81 BOWL DISK
540610	01 CENTERING TOOL	541487	82 BOWL DISK
540611	01 LIFTING EYE	541487	83 BOWL DISK

PART NO	DESCRIPTION	PART NO	DESCRIPTION
541602	30 DISTRIBUTING COVER	32302	0001 2 CYCLONE
541648	01 SEAL RING		
541648	02 SEAL RING		
541649	01 WEAR RING		
541649	02 WEAR RING		
541650	01 HOLDER FOR WEAR RING		
541651	01 HOLDER FOR WEAR RING		
541708	01 INLET HOUSING		
541709	30 ELBOW PIPE		
541790	30 CONNECTING PIECE		
541791	01 CONNECTION PIECE		
541794	01 SLEEVE		
541795	60 FEED TUBE, INNER		
541796	60 INLET TUBE, OUTER		
541805	02 MACHINE TOP PART		
541805	03 MACHINE TOP PART		
542077	00 WORK GEAR HOUSING OIL		
785352	02 ADJUSTING WASHER		
785668	01 NOZZLE		
785671	01 SHAFT		
785873	30 CLAMP SCREW COMPL		
785877	01 TUBE NUT		
900874	02 SEALING RIBBLE		
2 210403	23 SCREW		
2 210942	15 SCREW		
2 210942	30 SCREW		
2 210942	36 SCREW		
2 210942	37 SCREW		
2 210947	38 SCREW		
2 210947	16 SCREW		
2 210946	33 SCREW		
2 210953	21 SCREW		
2 211722	24 SCREW		
2 211722	25 SCREW		
2 211722	26 SCREW		
2 211724	32 SCREW		
2 216241	12 STUD BOLT		
2 216241	17 STUD BOLT		
2 216261	32 STUD BOLT		
2 217759	37 SCREW		
2 218043	04 NUT		
2 218043	19 NUT		
2 254121	21 SPRING		
2 254121	25 SPRING		
2 254121	37 SPRING		
31317	0554 1 WASHER		
31317	0554 1 COUPLING NUT		
31317	0554 1 GASKET		